

PRODUCT

GUIDE

YOUR SOLUTION FOR TILE ADHESIVES,  
GROUTS AND LEVELLERS



*Because we care*

---

**Since 1968** – when the Group was founded in Sassuolo at the heart of the most important ceramic district in the world, thanks to the business initiative of Romano Sghedoni – Kerakoll has been pursuing a clear course of development in Italian and international markets for building materials, that has taken the company **to the forefront of the GreenBuilding industry** and to a level of technological supremacy famous around the globe. Over the years, Kerakoll has achieved acclaim for its rapid and steady growth, proof of which can be seen in **revenues** which have risen from about 11 million euros in 1990 to **500 million euros in 2019**. With the gradual internationalisation of the business, 45% of the Group’s revenues are now generated through foreign sales. **In 2017 Kerakoll Group acquired 100% of Tilemaster Adhesive Ltd**, a leading UK company in the manufacturing and marketing of ceramic and natural stone laying systems.



66 innovative product ranges and  
4,600 eco-friendly items

5.4% of turnover is invested  
in green R&D

## Kerakoll GreenLab: world centre of excellence

The **9 eco-friendly advanced research and development laboratories** within the futuristic Kerakoll GreenLab represent the world's most advanced technology centre for the study and development of new materials for GreenBuilding. **The building houses more than 1,500 cutting-edge instruments**, with several points of excellence including: the Indoor Air Quality (IAQ) Lab for research on emissions and analysis of VOC, with 12 VOC rooms managed via software, constantly in operation and configured for the Indoortron at the Joint Research Centre in Ispra (VA), a European Commission research centre; the Klima Room, the first climactic room in Europe, developed alongside the Engineering Department of the University of Modena and Reggio Emilia (EELab, Energy Efficiency Laboratory), which is capable of determining the actual energy performance levels of a properly insulated wall.



15 mln/euro invested  
7,000 m<sup>2</sup> surface area

9 specialised laboratories  
over 140 green building researchers  
1,500 instruments

**For over 30 years**, Tilemaster Adhesives have been at the forefront of industry research, market evaluation and product development. These virtues have seen the successful growth of the company from small, humble beginnings in a small manufacturing plant on the outskirts of Preston, to what is in place today. The company's focus on listening to the market and reacting to the needs and requirements of the installer, retailer and distributor has seen the company release industry first **product innovations such as LevelFlex, Rapid Level 30, Ultimate and Setaflex Semi-Rapid** amongst others into the ceramics market, as well as venturing into the resilient flooring market where, again, the company's R&D focus has seen new innovations with unique product capabilities developed within this sector too, with products such as **Super Flow 30, FAST One Coat DPM** and the new adhesive range for resilient flooring **Eco-3000**.



£ 6.2 million has been projected to be invested into the expansion of Tilemaster by 2024; enhancing the production plant with new machinery and improved R&D facilities, re-locating the distribution centre and refurbishing the offices

As part of Tilemaster's continuous development, our employment force has grown from 56 people in 2018 to 122 by 2021; that is an increase rate of 118%

## Our story so far

Today the company continues the R&D focus that has been the focal point of the business since the early years, with new development projects continuing to be thought out, put into practice and released to market. Products such as **the new LevelFlex + DEPTH and LevelFlex+ FINISH** that have been developed specifically for the ceramic and resilient flooring markets respectively, with one focus and aim in mind – to continue to provide the very best possible products and materials to our customer and distribution network and, in turn, the industry. With the addition of the expertise of the **Kerakoll Group**, Tilemaster Adhesives continue to focus on innovative new products for the market whilst maintaining superb levels of service, offering expert technical knowledge and having in depth commercial awareness. This offering to the Companies dedicated and loyal customer network, from installers, retailers, distributors and homeowners maintains **Tilemaster Adhesives as a leader in the ceramics and resilient flooring markets.**



**July of 2017 saw Kerakoll S.p.A acquire Tilemaster Adhesives.** The aim of the acquisition was for the two brands to continue to run separately in the UK and enable the Group to invest in Tilemaster. This investment would see expansion of the production plant in Leyland, identification of an additional UK production site, construction of a new research & development centre and a full revamp of the existing Tilemaster offices. Overtime, the acquisition will also allow for both product ranges to be extended and for the introduction of new Kerakoll technologies into Tilemaster. Ultimately the rationale behind the acquisition and merger of the two companies is to establish Kerakoll Group as a market leader in the UK tiling and flooring industry, and this is just the beginning.

# General contents

## Introduction

- 8 Movement joints
- 9 European Standards

## Substrate preparation

- 12 Primeplus
- 13 Prime+ Grip
- 14 Tanking Kit
- 14 Tanking Paste
- 14 Tanking Tape
- 14 Self Adhesive Waterproof Tanking Tape
- 14 Internal Corner
- 14 External Corner
- 15 Anti-Fracture Mat
- 16 FAST One Coat DPM
- 17 Hygrometer

## Smoothing and levelling compounds

- 20 Rapid Repair Mortar+
- 21 Tilemaster Feather
- 22 FineFlow 3000
- 23 LevelFlex+ DEPTH
- 24 LevelFlex+ FINISH
- 25 Rapid Level 30
- 26 External Leveller
- 27 Trade Flow
- 28 Pro Flow
- 29 Super Flow 30



## **Laying ceramic, porcelain and natural stone tiles**

- 32 Flexmaster
- 33 Trade FlexiRapid
- 34 Standard Set Setaflex
- 35 Setaflex Semi-Rapid
- 36 Rapid Setaflex
- 37 Ultimate
- 38 Grout 3000
- 39 Silicone 3000+
- 40 Grout 3000 and Silicone 3000+ codes
- 41 Grout 3000 and Silicone 3000+ colours
- 42 Tile Adhesive Selector

## **Laying resilient flooring**

- 46 Eco-3000 HT
- 47 Eco-3000 PS

## **Laying systems**

- 48 Systems index
- 50 Substrate priming guide

# Movement joints

Movement/expansion joints are an essential part of tiling. Tiling can be affected by stresses in the substrate such as shrinkage, deflection, moisture movement and thermal expansion/contraction. This can result in tiles losing adhesion, de-bonding and/or cracking.

The solution is to incorporate movement joints through the tile and the adhesive bed. Movement joints should be placed wherever movement is likely to occur.

## Interior wall tiling

---

Movement joints should be incorporated:

- Over existing and/or structural movement joints
- Where tiling abuts other materials
- Where tiling is continuous across junctions of different background materials
- In large tiled areas, at internal corners and at 3 – 4.5 metre centres both horizontally and vertically
- Where stresses are likely to be concentrated, e.g. at changes of alignment

## Exterior wall tiling

---

Incorporate movement joints as per the instructions above for internal wall tiling and, in addition:

- At storey heights horizontally and 3 – 4.5 metres apart vertically
- At external angles, vertically 0.25 – 1 metres from the angle and symmetrically where possible
- Where an intermediate substrate is used, the movement joints should extend through it

## Interior and exterior floor tiling

---

Movement joints should be incorporated:

- Over existing and/or structural movement joints
- Around the perimeter of the floor, in door openings and where tiling abuts columns, curbs, steps and permanent fixtures
- Where tiling is across junctions of different base materials
- On large floor areas of solid substrates and well prepared timber substrates expansion joints should be incorporated every 80 – 100 m<sup>2</sup>.
- Where the substrate has underfloor heating expansion joints should be every 40 m<sup>2</sup> and when fixing resin agglomerated tiles joints should be every 25 m<sup>2</sup>. ***On suspended floors, the bay size should be reduced and additional joints provided over supporting walls and beams.***

*Please Note: the above information is included as a guide only, for specific movement joint details, advice should be sought from an expert in this field.*

# European Standards

All Tilemaster products are manufactured in accordance with European Standards and meet or exceed the classifications that define the type and properties of each product.

SYMBOL TYPE	CLASS	DESCRIPTION
-------------	-------	-------------

## Adhesives under BS EN 12004

C	1	Normal cement based adhesive
C	1F	Fast setting cement based adhesive
C	1T	Normal cement based adhesive with reduced slip
C	1E	Normal cement based adhesive with extended open time
C	1TE	Normal cement based adhesive with extended open time and reduced slip
C	1FT	Fast setting cement based adhesive with reduced slip
C	2	Improved cement based adhesive with additional characteristics
C	2E	Improved cement based adhesive with additional characteristics and an extended open time
C	2F	Improved, fast setting cement based adhesive with additional characteristics
C	2T	Improved cement based adhesive with additional characteristics and reduced slip
C	2TE	Improved cement based adhesive with additional characteristics, reduced slip and an extended open time
C	2FT	Improved, fast setting cement based adhesive with additional characteristics and reduced slip

## Adhesives under BS EN 12002: 2008

S	1	Deformable adhesive
S	2	Highly deformable adhesive

## Grouts under BS EN 13888: 2009

CG	1	Cement based grout with normal characteristics
CG	2W	Improved cement based grout with additional characteristics of reduced water absorption
CG	2A	Improved cement based grout with additional characteristics of high abrasion resistance
CG	2WA	Improved cement based grout with additional characteristics of reduced water absorption and high abrasion resistance



# Substrate preparation

- 12 Primeplus
- 13 Prime+ Grip
- 14 Tanking Kit
- 14 Tanking Paste
- 14 Tanking Tape
- 14 Self Adhesive Waterproof Tanking Tape
- 14 Internal Corner
- 14 External Corner
- 15 Anti-Fracture Mat
- 16 FAST One Coat DPM
- 17 Hygrometer

# Primeplus

Universal priming and bonding agent.

Tilemaster Primeplus is a butadiene polymer designed to prime, stabilise and seal substrates prior to the application of tile adhesives and levelling compounds. Primeplus increases the adhesion and prolongs the working time of tile adhesives and levelling compounds. Primeplus is suitable for use internally and externally.



- **Wall and floor primer for absorbent surfaces**
- **Designed to prime and stabilise substrates whilst increasing adhesion and working times of tile adhesives and levelers**
- **Pigmented for ease of application**

## Substrates

- |  |                              |
|--|------------------------------|
| ✓ Sand/cement screed                                   | ✓ Plasterboard               |
| ✓ Concrete   | ✓ Cement/sand render         |
| ✓ Plywood overlay                                      | ✓ Concrete brick/block       |
| ✓ Electric underfloor heating                          | ✓ T & G floorboards          |
| ✓ Water/wet system                                     | ✓ Floating floors            |
| ✓ Underfloor heating                                   | ✓ Existing vinyl tiles*      |
| ✓ Tile backer boards                                   | ✓ Steel/metal surfaces*      |
| ✓ Existing ceramic, porcelain and natural stone tiles* | ✓ Epoxy DPM*                 |
| ✓ Flooring grade asphalt and bitumen*                  | ✓ Existing adhesive residues |
| ✓ Calcium sulphate screeds                             | ✓ Fibreglass*                |
| ✓ Plaster  | ✓ Green screed               |

*\* Primeplus slurry coat*

Coverage	1 ℓ applied neat will cover 10 m <sup>2</sup> diluted with 3 parts water, 1 ℓ will cover 40 m <sup>2</sup> applied as a slurry coat, 1 ℓ will cover 18 m <sup>2</sup>
Drying time	absorbent surfaces 30 – 60 minutes, non-absorbent surfaces 45 – 90 minutes
Application temperature	+5 °C to +30 °C
Colour	light green
Pack sizes	1 ℓ / 5 ℓ bottles
Product type	styrene butadiene co-polymer (SBR), non-hazardous
Pallet size	1 ℓ – 720 units per pallet 5 ℓ – 160 units per pallet
Code	KA0173 – 1 ℓ KA0174 – 5 ℓ

# Prime+ Grip

## Multi-purpose bond enhancing primer.

Tilemaster Prime+ Grip is a ready mixed, ready to use bond enhancing primer that can be used onto non-absorbent substrates. Prime+ Grip is rapid drying and it can be tiled or levelled over after 15 minutes. Prime+ Grip is suitable for use internally and externally.



- **Significantly improves adhesion bond strength of tile adhesives and levelling compounds onto non-porous substrates**
- **Rapid drying – dry in as little as 15 minutes**
- **Apply straight from bottle – no need to dilute**

### Substrates

- ✓ Sand/cement screed
- ✓ Concrete
- ✓ Plywood overlay
- ✓ Electric underfloor heating
- ✓ Water/wet system underfloor heating
- ✓ Tile backer boards
- ✓ Existing ceramic, porcelain and natural stone tiles
- ✓ Flooring grade asphalt and bitumen
- ✓ Calcium sulphate screeds
- ✓ Plaster
- ✓ Plasterboard
- ✓ Cement/sand render
- ✓ Concrete brick/block
- ✓ T & G floorboards
- ✓ Floating floors
- ✓ Existing vinyl tiles
- ✓ Steel/metal surfaces
- ✓ Epoxy DPM
- ✓ Existing adhesive residues
- ✓ Fibreglass
- ✓ Green screed

Coverage	45 – 65 m <sup>2</sup> per 5 kg unit
Drying time	15 – 20 minutes in ideal conditions
Application temperature	+5 °C to +30 °C
Colour	blue
Pack sizes	1 kg / 5 kg buckets
Product type	acrylic co-polymer, non-hazardous
Pallet size	1 kg – 480 units per pallet 5 kg – 160 units per pallet
Code	KA0348 – 1 kg KA0177 – 5 kg

# Tanking Kit & Tanking Paste

Waterproofing kit for areas exposed to wet / damp conditions.



Tilemaster Tanking Paste is a single coat, fast drying waterproofing system based on co-polymer technology. It produces a barrier to moisture that is flexible enough to accommodate slight movement and/or vibration expected under normal conditions of use in and around well constructed, structurally stable floors, walls and shower cubicles.

*The Tilemaster Tanking Kit comprises of a pre-mixed, easy to use waterproofing paste that is reinforced with fleece tape and preformed corners. All contents of the Tilemaster Tanking Kit can be purchased individually.*

- **Protects water sensitive substrates from exposure to water**
- **Single coat system, no priming required**
- **Fast drying, apply tiles after 3 hours**

## Substrates

- |   |                                      |
|---|--------------------------------------|
| ✓ Sand/cement screed                                  | ✓ Flooring grade asphalt and bitumen |
| ✓ Concrete  | ✓ Calcium sulphate screeds           |
| ✓ Plywood overlay                                     | ✓ Plaster                            |
| ✓ Electric underfloor heating                         | ✓ Plasterboard                       |
| ✓ Water/wet system underfloor heating                 | ✓ Cement/sand render                 |
| ✓ Tile backer boards                                  | ✓ Concrete brick/block               |
| ✓ Existing ceramic, porcelain and natural stone tiles | ✓ T & G floorboards                  |

Contents	2.5 kg Tanking Paste, 10 m roll of Tanking Tape, 2 Internal Corners and disposable gloves
Coverage	2.5 kg Tanking Paste covers approximately 7 m <sup>2</sup>
Drying time	in ideal conditions tiling can commence after 3 hours providing the coat is touch dry
Application temperature	+5 °C to +30 °C
Paste colour	blue
Pack weight	3.5 kg (Tanking Kit)
Pallet size	2.5 kg Tanking Paste – 166
Code	KA0167 – Tanking Kit 3.5 kg KA0168 – Tanking Paste 2.5 kg

## Also available



Tanking Tape  
KA0170



Self Adhesive Waterproof Tanking Tape  
KA0169



Internal Corner  
KA0166



External Corner  
KA0165



# Anti-Fracture Mat

Uncoupling / decoupling matting for floors subject to lateral movement.

Tilemaster Anti-Fracture Mat is an uncoupling / decoupling mat designed for use on floor tile installations to prevent substrate lateral movement from cracking the tiled finish. Tilemaster Anti-Fracture Mat can be used in a wide range of applications to absorb lateral movement from substrates and to bridge stress / shrinkage cracking in substrates to prevent such movement being transferred to the tiled finish.



- **Three layer uncoupling / decoupling mat designed to accommodate and absorb lateral movement in sub-floors**
- **Prevents substrate lateral movement from cracking the tiled finish**
- **Suitable for use with timber substrates and underfloor heating systems**

## Substrates

- ✓ Sand/cement screed
- ✓ Concrete
- ✓ Plywood overlay
- ✓ Electric underfloor heating
- ✓ Water/wet system underfloor heating
- ✓ Tile backer boards
- ✓ Existing ceramic, porcelain and natural stone tiles
- ✓ Flooring grade asphalt and bitumen
- ✓ Calcium sulphate screeds
- ✓ T & G floorboards
- ✓ Floating floors
- ✓ Existing vinyl tiles
- ✓ Steel/metal surfaces
- ✓ Fibreglass

Composition	three layer composition, two outer layers of non-woven polypropylene with an inner butyl layer
Colour	grey base layer with a white branded top layer
Sheet thickness	0.85 mm
Sheet weight	450 g per m <sup>2</sup>
20 m roll weight	approximately 9.2 kg
Roll size	20 m roll x 1 m wide
Pallet size	30 rolls
Code	KA0159

# FAST One Coat DPM

Fast curing, epoxy based surface damp proof membrane.

Tilemaster FAST One Coat DPM is a two component, solvent free, one coat epoxy Damp Proof Membrane. FAST One Coat DPM is suitable for use as a one coat application on a wide range of substrates including concrete, sand and cement screeds and calcium sulphate screeds. FAST One Coat DPM is suitable for application onto cementitious screeds where moisture content readings are up to 98% Relative Humidity (RH) and calcium sulphate screeds where the moisture content reading is up to 95% RH, and 90% RH for heated calcium sulphate screeds. FAST One Coat DPM can also be used as a one coat application to deal with damp substrates where a structural Damp Proof Membrane is not present, or where the Damp Proof Membrane is ineffective.



- **True one coat system to create structural damp proof membrane**
- **Suitable for use onto cementitious and calcium sulphate screeds - including with underfloor heating**
- **Trowel and gloves included**

## Substrates

- |                                       |   |
|---------------------------------------|---|
| ✓ Sand/cement screed                  | ✓ Existing ceramic, porcelain and natural stone tiles |
| ✓ Concrete                            | ✓ Flooring grade asphalt                              |
| ✓ Water/wet system underfloor heating | ✓ Calcium sulphate screeds                            |

Coverage	When applied to a smooth surface using an A2 trowel: a 3 kg unit will cover up to approximately 7.5 m <sup>2</sup> a 7 kg unit will cover up to approximately 17.5 m <sup>2</sup> a 14 kg unit will cover up to approximately 35 m <sup>2</sup>
Working time	approximately 20 minutes at 23 °C
Cure time	approximately 4 – 5 hours at 23 °C
Application temperature	+10 °C to +30 °C
Colour	dark metallic
Pack sizes	3 kg / 7 kg / 14 kg
Pallet size	3 kg – 105 units per pallet 7 kg – 80 units per pallet 14 kg – 60 units per pallet
Code	KA0172 – 3 kg KA0402 – 7 kg KA0403 – 14 kg

# Hygrometer

Tilemaster Hygrometer is designed to measure the moisture content of a subfloor in Relative Humidity (RH) prior to installing floor coverings. The subfloor can be considered dry when reaching the desired RH level and is within the parameters set out for installation of the respective Tilemaster Adhesives product to the surface.



- **Digital readout for accurate RH% readings**
- **Suitable for cement based and calcium sulphate based screeds**
- **Non-destructive test method**

Pack size	1 pc.
Code	KA0393



# Smoothing and levelling compounds

- 20 Rapid Repair Mortar+
- 21 Tilemaster Feather
- 22 FineFlow 3000
- 23 LevelFlex+ DEPTH
- 24 LevelFlex+ FINISH
- 25 Rapid Level 30
- 26 External Leveller
- 27 Trade Flow
- 28 Pro Flow
- 29 Super Flow 30

# Rapid Repair Mortar+

Moisture tolerant rapid repair mortar.



Tilemaster Rapid Repair Mortar+ is a rapid drying, moisture tolerant repair compound, ideal for repairing, filling and patching floors and walls. Rapid Repair Mortar+ is suitable for creating ramps and forming coves around room perimeters. Rapid Repair Mortar+ can be walked on after 30 minutes, and installed onto after 90 minutes. Rapid Repair Mortar+ is suitable for use internally and externally.

- **Apply from 2 mm – 50 mm unfilled, 5 mm – 80 mm filled**
- **Moisture tolerant – can be used beneath Epoxy DPMs**
- **Apply finished flooring after 90 minutes**

## Substrates

- |   |   |
|---|---|
| <ul style="list-style-type: none"> <li>✓ Sand/cement screed</li> <li>✓ Concrete</li> <li>✓ Electric underfloor heating*</li> <li>✓ Water/wet system underfloor heating*</li> <li>✓ Tile backer boards</li> <li>✓ Existing ceramic, porcelain and natural stone tiles</li> </ul> | <ul style="list-style-type: none"> <li>✓ Calcium sulphate screeds**</li> <li>✓ Plaster</li> <li>✓ Plasterboard</li> <li>✓ Cement/sand render</li> <li>✓ Concrete brick/block</li> </ul> |
|---|---|

\* When mixed with Flexmaster Additive  
\*\* Additional substrate preparation required

Water addition	1.9 – 2.2 ℓ of water to 11 kg Rapid Repair Mortar+
Coverage	11 kg pack will cover 7 m <sup>2</sup> at a depth of 1 mm
Working time	once mixed, Rapid Repair Mortar+ remains workable for approx. 10 minutes
Drying time	light foot traffic after 15 – 20 minutes
Ready for covering	install resilient floor coverings after 60 – 90 minutes
Application temperature	+5 °C to +30 °C
Colour	grey
Pack sizes	11 kg
Pallet size	90 bags
Code	KA0399



# Tilemaster Feather

Rapid drying patch repair and smoothing compound



Tilemaster Feather is a rapid drying, ultra-fine patch-repair compound developed for use on a large variety of substrates prior to the installation of final floor coverings. Tilemaster Feather is ideal for patching and feathering depressions, trowel marks, ridges, gouges and day-work joints in the sub-floor, as well as for smoothing over screw-heads and joints between sheets of plywood.

- **Rapid drying, floor coverings can be applied after as little as 15 minutes**
- **Ideal for filling joints and screw holes in plywood overlay**
- **Can be applied as a true scrape coat - coverage of 50 m<sup>2</sup> per 11 kg bag**

## Substrates

- |                                       |  |
|---------------------------------------|--|
| ✓ Sand/cement screed                  | ✓ Flooring grade asphalt and bitumen           |
| ✓ Concrete                            | ✓ Calcium sulphate screeds* (requires priming) |
| ✓ Plywood overlay (6 mm min.)         | ✓ Fibre cement sheet                           |
| ✓ Electric underfloor heating         | ✓ T & G floorboards                            |
| ✓ Water/wet system underfloor heating | ✓ Floating floors                              |
| ✓ Tile backer boards                  | ✓ Existing vinyl tiles                         |
| ✓ Existing floor tiles                |  |

\* Additional substrate preparation required

Coverage	approximately 50 m <sup>2</sup> when used as skim coat
Application thickness	0 – 3 mm
Working time	approximately 15 minutes at 23 °C
Drying time	install resilient floor coverings after 15 minutes
Colour	grey
Pack sizes	11 kg
Pallet size	80 bags
Code	KA0203



# FineFlow 3000

Exceptional flowing smoothing and levelling floor compound.

FineFlow 3000 is a fast setting, free flowing, protein free cement based self levelling and smoothing compound designed for smoothing and levelling subfloors prior to the installation of floor coverings. FineFlow 3000 can be applied from depths of feather edge – 20 mm in one application and it is suitable for use on all common solid substrates including underfloor heating systems.



- **Apply from featheredge – 20 mm in one application**
- **Ideal for use above underfloor heating systems**
- **Excellent levelling and smoothing properties**

## Substrates

- ✓ Sand/cement screed
- ✓ Concrete
- ✓ Electric underfloor heating
- ✓ Water/wet system underfloor heating
- ✓ Tile backer boards
- ✓ Existing ceramic, porcelain and natural stone tiles\*
- ✓ Flooring grade asphalt and bitumen\*
- ✓ Calcium sulphate screeds\*\*
- ✓ Existing vinyl tiles\*
- ✓ Epoxy DPM\*

\* Prime with Prime+ Grip

\*\* Additional substrate preparation required

Water addition	4.4 - 4.8 ℓ of water to 20 kg FineFlow 3000
Coverage	20 kg will cover 4.2 m <sup>2</sup> at a depth of 3 mm
Working time	once mixed, FineFlow 3000 remains workable for 20 – 25 minutes
Drying time	light foot traffic after 2 – 3 hours
Ready for covering	install resilient floor coverings after 24 hours
Application temperature	+5 °C to +30 °C
Colour	grey
Pack sizes	20 kg
Pallet size	48 bags
Code	KA0072





# LevelFlex+ DEPTH

Flexible, fibre reinforced, rapid setting smoothing and levelling floor compound.



Tilemaster LevelFlex+ DEPTH is a flexible, fibre reinforced, rapid setting smoothing and levelling compound designed to prepare subfloors prior to the installation of ceramic, porcelain and natural stone tiles. LevelFlex+ DEPTH has been developed for application depths up to 85mm in one application, and can accept foot traffic and tiles to be installed after 2.5 hours, and is suitable for use onto underfloor heating systems, including retrofit overlay systems.

- **Apply from 2 mm – 85 mm in one application**
- **Rapid setting, walk on and tile after 2.5 hours**
- **Excellent flow properties & workability**

## Substrates

- |  |                              |
|--|------------------------------|
| ✓ Sand/cement screed                                   | ✓ Calcium sulphate screeds** |
| ✓ Concrete   | ✓ T & G floorboards          |
| ✓ Plywood overlay (6mm min.)                           | ✓ Floating floors            |
| ✓ Electric underfloor heating                          | ✓ Existing vinyl tiles*      |
| ✓ Water/wet system underfloor heating                  | ✓ Steel/metal surfaces*      |
| ✓ Tile backer boards                                   | ✓ Epoxy DPM*                 |
| ✓ Existing ceramic, porcelain and natural stone tiles* | ✓ Fibreglass*                |
| ✓ Flooring grade asphalt and bitumen*                  | ✓ Green screed               |

\* Prime with Prime+ Grip

\*\* Additional substrate preparation required

Water addition	4.5 - 5.0 ℓ of water to 20 kg LevelFlex+ DEPTH
Coverage	20 kg will cover 4.5 m <sup>2</sup> at a depth of 3 mm
Working time	once mixed, LevelFlex+ DEPTH remains workable for approx. 35 minutes
Drying time	light foot traffic after 2.5 hours
Ready for covering	tile after 2.5 hours
Application temperature	+5 °C to +30 °C
Colour	grey
Pack sizes	20 kg
Pallet size	48 bags
Code	KA0398



# LevelFlex+ FINISH

Flexible, fibre reinforced, rapid setting smoothing and levelling floor compound.



Tilemaster LevelFlex+ FINISH is a flexible, fibre reinforced, rapid setting smoothing compound developed to provide a superb surface finish, allowing for the installation of floor coverings directly to the surface without the need for additional finishing products. LevelFlex+ FINISH can accept foot traffic after 2.5 hours and resilient floor coverings applied after as little as 4 hours. LevelFlex+ FINISH is moisture tolerant, enabling the product to be used beneath Epoxy DPM's, and can be applied to depths between 2 mm – 60 mm in one application.

- **Superb surface finish – ideal for resilient flooring**
- **Rapid setting, walk on after 2.5 hours and install after 4 hours**
- **Moisture tolerant – suitable for use beneath Epoxy DPM's**

## Substrates

- |  |                              |
|--|------------------------------|
| ✓ Sand/cement screed                                   | ✓ Calcium sulphate screeds** |
| ✓ Concrete   | ✓ T & G floorboards          |
| ✓ Plywood overlay (6mm min.)                           | ✓ Floating floors            |
| ✓ Electric underfloor heating                          | ✓ Existing vinyl tiles*      |
| ✓ Water/wet system underfloor heating                  | ✓ Steel/metal surfaces*      |
| ✓ Tile backer boards                                   | ✓ Epoxy DPM*                 |
| ✓ Existing ceramic, porcelain and natural stone tiles* | ✓ Fibreglass*                |
| ✓ Flooring grade asphalt and bitumen*                  | ✓ Green screed               |

\* Prime with Prime+ Grip

\*\* Additional substrate preparation required

Water addition	4.5 - 5.0 l of water to 20 kg LevelFlex+ DEPTH
Coverage	20 kg will cover 4.5 m <sup>2</sup> at a depth of 3 mm
Working time	once mixed, LevelFlex+ FINISH remains workable for approx. 35 minutes
Drying time	light foot traffic after 2.5 hours
Ready for covering	install resilient floor coverings after 4 hours
Application temperature	+5 °C to +30 °C
Colour	grey
Pack sizes	20 kg
Pallet size	48 bags
Code	KA0397



# Rapid Level 30

Ultra-rapid setting, flexible levelling and smoothing floor compound.

Tilemaster Rapid Level 30 is an ultra-rapid setting, flexible self levelling and smoothing floor compound. Rapid Level 30 has been formulated to provide a surface that can be walked on after 30 minutes and it is ready to receive ceramic, porcelain and natural stone tiles after 45 – 60 minutes. Rapid Level 30 can be applied from depths of 2 mm – 15 mm in one application and it is suitable for use on all common substrates including underfloor heating systems and timber substrates.



- Can accept foot traffic after 30 minutes
- Tile after 45 – 60 minutes
- Apply from 2 mm – 15 mm in one application

## Substrates

- ✓ Sand/cement screed
- ✓ Concrete
- ✓ Plywood overlay (6mm min.)
- ✓ Electric underfloor heating
- ✓ Water/wet system underfloor heating
- ✓ Tile backer boards
- ✓ Existing ceramic, porcelain and natural stone tiles\*
- ✓ Calcium sulphate screeds\*\*
- ✓ Epoxy DPM\*

\* Prime with Prime+ Grip

\*\* Additional substrate preparation required

Water addition	4.5 - 5.0 ℓ of water to 20 kg Rapid Level 30
Coverage	20 kg will cover 4.2 m <sup>2</sup> at a depth of 3 mm
Working time	once mixed, Rapid Level 30 remains workable for 10 – 15 minutes
Drying time	light foot traffic after 30 minutes
Ready for covering	tile after 45 – 60 minutes
Application temperature	+5 °C to +30 °C
Colour	beige
Pack sizes	20 kg
Pallet size	48 bags
Code	KA0089



# External Leveller

External levelling floor compound.

Tilemaster External Leveller is a fast setting, fibre reinforced self levelling and smoothing compound formulated especially for smoothing and levelling subfloors externally prior to the installation of floorcoverings. External Leveller is fast setting and therefore ceramic, porcelain and natural stone tiles can be applied after 3 hours. External Leveller is also suitable for use in swimming pools prior to the finished covering being applied.



- **Specifically developed for use externally and in swimming pools**
- **Apply from 2 mm – 50 mm in one application**
- **Can be used as a wearing surface**

## Substrates

- ✓ Sand/cement screed
- ✓ Concrete
- ✓ Tile backer boards
- ✓ Existing ceramic, porcelain and natural stone tiles\*
- ✓ Epoxy DPM\*

\* Prime with Prime+ Grip

Water addition	4.8 – 5.0 l of water to 25 kg External Leveller
Coverage	25 kg will cover 5.0 m <sup>2</sup> at a depth of 3 mm
Working time	once mixed, External Leveller remains workable for 20 – 25 minutes
Drying time	light foot traffic after 2 – 3 hours
Ready for covering	tile after 3 hours
Application temperature	+5 °C
Colour	grey
Pack sizes	25 kg
Pallet size	40 bags
Code	KA0368



# Trade Flow

Multi-purpose, double component smoothing and levelling compound.

Tilemaster Trade Flow is a multi-purpose double component smoothing and levelling compound, suitable for a wide range of commercial and domestic applications. Trade Flow is suitable for use over a wide range of substrates. Trade Flow will accept light foot traffic after 2 hours in ideal conditions and installation of resilient floor coverings after 12 hours.



- Suitable for use with underfloor heating systems
- Apply from 2 mm – 12 mm in one application
- Protein free

## Substrates

- |  |  |
|--|--|
| <ul style="list-style-type: none"> <li>✓ Sand/cement screed</li> <li>✓ Concrete</li> <li>✓ Plywood overlay (15 mm min.)</li> <li>✓ Electric underfloor heating</li> <li>✓ Water/wet system underfloor heating</li> <li>✓ Tile backer boards</li> </ul> | <ul style="list-style-type: none"> <li>✓ Existing ceramic, porcelain and natural stone tiles*</li> <li>✓ Flooring grade asphalt and bitumen*</li> <li>✓ Calcium sulphate screeds**</li> <li>✓ Existing vinyl tiles*</li> <li>✓ Epoxy DPM*</li> </ul> |
|--|--|

\* Prime with Prime+ Grip

\*\* Additional substrate preparation required

Coverage	20 kg will cover 5 m <sup>2</sup> at a depth of 3 mm
Working time	once poured, Trade Flow remains workable for 20 – 25 minutes
Drying time	light foot traffic after 2 – 3 hours
Ready for covering	install resilient flooring after 12 hours
Application temperature	+5 °C to +30 °C
Colour	grey
Pack sizes	20 kg bag with 5 l of liquid
Pallet size	40 bags & 40 bottles
Code	Trade Flow powder - KA0099 Trade Flow liquid - KA0100



# Pro Flow

High performance, double component, flexible smoothing and levelling compound.

Tilemaster Pro Flow is a rapid setting, high performance double component smoothing and levelling compound offering excellent flow and adhesion properties without the need to prime the large majority of substrates. Pro Flow will accept light foot traffic after 90 minutes and resilient floor coverings can be installed after 4 hours. Pro Flow can be applied from depths of 2 mm – 12 mm in one application and is moisture tolerant.



- **Suitable for use over old adhesive residues including bitumen**
- **Excellent adhesion properties without priming most substrates**
- **Install resilient floor coverings after 4 hours**

## Substrates

- |   |                                      |
|---|--------------------------------------|
| ✓ Sand/cement screed                                  | ✓ Flooring grade asphalt and bitumen |
| ✓ Concrete  | ✓ Calcium sulphate screeds**         |
| ✓ Plywood overlay (6 mm min.)                         | ✓ Steel/metal surfaces*              |
| ✓ Electric underfloor heating                         | ✓ Epoxy DPM*                         |
| ✓ Water/wet system underfloor heating                 | ✓ Existing adhesive residues         |
| ✓ Tile backer boards                                  | ✓ Fibreglass*                        |
| ✓ Existing ceramic, porcelain and natural stone tiles | ✓ Green screed                       |

\* Prime with Prime+ Grip

Epoxy DPM: if DPM is more than 24 hours old, prime with Prime+ Grip

\*\* Additional substrate preparation required

Coverage	20 kg will cover 5 m <sup>2</sup> at a depth of 3 mm
Working time	once mixed, Pro Flow remains workable for 20 – 25 minutes
Drying time	light foot traffic after 90 minutes
Ready for covering	install resilient floor coverings after 4 hours
Application temperature	+5 °C to +30 °C
Colour	grey
Pack sizes	20 kg bag with 5 l of liquid
Pallet size	40 bags & 40 bottles
Code	Pro Flow powder - KA0084 Pro Flow liquid - KA0085



# Super Flow 30

Ultra-rapid setting, high performance, double component, flexible smoothing and levelling compound.



Tilemaster Super Flow 30 is an ultra-rapid setting, high performance double component smoothing and levelling compound offering excellent flow and adhesion properties without the need to prime the large majority of substrates when a true fast-track solution is required. Super Flow 30 will accept light foot traffic after 45 minutes and resilient floor coverings can be installed after 90 minutes. Super Flow 30 can be applied from depths of 2 mm – 15 mm in one application and is moisture tolerant.

- **Walk on after 45 minutes and install resilient floor coverings after 90 minutes**
- **Suitable for use over old adhesive residues including bitumen**
- **Excellent adhesion properties without priming most substrates**

## Substrates

- |   |                              |
|---|------------------------------|
| ✓ Sand/cement screed                                  | ✓ Calcium sulphate screeds** |
| ✓ Concrete  | ✓ Existing vinyl tiles       |
| ✓ Plywood overlay (6 mm min.)                         | ✓ Steel/metal surfaces*      |
| ✓ Electric underfloor heating                         | ✓ Epoxy DPM*                 |
| ✓ Water/wet system underfloor heating                 | ✓ Existing adhesive residues |
| ✓ Tile backer boards                                  | ✓ Fibreglass*                |
| ✓ Existing ceramic, porcelain and natural stone tiles | ✓ Green screed               |
| ✓ Flooring grade asphalt and bitumen                  |                              |

\* Prime with Prime+ Grip

Epoxy DPM: if DPM is more than 24 hours old, prime with Prime+ Grip

\*\* Additional substrate preparation required

Coverage	20 kg will cover 4.5 m <sup>2</sup> at a depth of 3 mm
Working time at +23 °C	once mixed, Super Flow 30 remains workable for approx. 10 – 15 minutes
Drying time	light foot traffic after 45 minutes
Ready for covering	install resilient floor coverings after 90 minutes
Application temperature	+5 °C to +30 °C
Colour	beige
Pack sizes	20 kg bag with 4.5 l liquid
Pallet size	40 bags & 40 bottles
Code	Super Flow 30 powder - KA0092 Super Flow 30 liquid - KA0093







# Laying ceramic, porcelain and natural stone tiles

- 32 Flexmaster
- 33 Trade FlexiRapid
- 34 Standard Set Setaflex
- 35 Setaflex Semi-Rapid
- 36 Rapid Setaflex
- 37 Ultimate
- 38 Grout 3000
- 39 Silicone 3000+

# Flexmaster

Multi purpose flexible additive.

Tilemaster Flexmaster is a highly advanced acrylic based polymer, which can be used as an additive in Tilemaster tile adhesives and grouts. Flexmaster increases the flexibility, durability, adhesion properties and water resistance of Tilemaster tile adhesives and grouts. Flexmaster is undiluted and as a result can be adapted/diluted to meet site requirements.



- **Multi-purpose flexible additive increases the flexural properties and adhesion properties of tile adhesives and grouts**
- **Improves the durability and water resistance of Tilemaster tile adhesives and grouts**
- **Can be added to most Tilemaster adhesives and grouts**

Coverage	5 ℓ of Flexmaster mixed with 3 parts water produces enough flexible additive for 80 kg of tile adhesive
Dilution rates	vary depending on the application, please refer to the product packaging
Application temperature	+5 °C to +30 °C
Colour	white
Pack sizes	1 ℓ / 5 ℓ bottles
Product type	acrylic co-polymer, non-hazardous
Pallet size	1 ℓ – 720 bottles 5 ℓ – 160 bottles
Code	KA0289 – 1 ℓ KA0287 – 5 ℓ

# Trade FlexiRapid

Flexible rapid setting floor and wall tile adhesive.

Trade FlexiRapid is a flexible rapid setting floor and wall tile adhesive with increased adhesion and non-slip properties. Trade FlexiRapid is suitable for fixing ceramic, porcelain and natural stone tiles to well prepared substrates such as plywood overlay and underfloor heating systems. Trade FlexiRapid will allow light foot traffic and grouting after 3 hours. Trade FlexiRapid can be used internally and externally and it is unaffected by frost after setting.



- Suitable for use with underfloor heating systems
- Suitable for installing ceramic, porcelain and natural stone tiles
- Walk on and grout after 3 hours

Tiles	Substrates
✓ Ceramics	✓ Sand/cement screed
✓ Porcelain	✓ Concrete
✓ Marble	✓ Plywood overlay (15 mm min.)
✓ Travertine	✓ Electric underfloor heating
✓ Limestone	✓ Water/wet system underfloor heating
✓ Slate	✓ Tile backer boards
✓ Granite	✓ Existing ceramic, porcelain and natural stone tiles*
✓ Terracotta	✓ Flooring grade asphalt and bitumen*
✓ Mosaics	✓ Calcium sulphate screeds**
✓ Quarry	✓ Plaster
	✓ Plasterboard
	✓ Cement/sand render
	✓ Concrete brick/block
	✓ Existing vinyl tiles*
	✓ Epoxy DPM*

\* Prime with Prime+ Grip

\*\* Additional substrate preparation required

Water addition	4.2 – 4.6 ℓ of water to 20 kg Trade FlexiRapid
Coverage	20 kg will cover 5 – 6 m <sup>2</sup> at 3 mm thin bed application
Pot life at 20 °C	approximately 30 – 45 minutes
Grout after	3 hours
Application temperature	+5 °C to +30 °C
Colour	grey / white
Pack sizes	20 kg
Pallet size	48 bags
Code	KA0045 – grey KA0046 – white



# Standard Set Setaflex

S1 flexible standard setting wall and floor tile adhesive.



Tilemaster Standard Set Setaflex is an S1 flexible, standard setting wall and floor tile adhesive with increased adhesion and non-slip properties. Standard Set Setaflex is suitable for installing ceramic, porcelain and natural stone tiles to substrates subject to limited movement and/or vibration and is ideal for use above underfloor heating systems. Standard Set Setaflex allows for additional working time with a pot life of 3 – 4 hours. Standard Set Setaflex can be used internally and externally and it is unaffected by frost after setting.

- **Genuine S1 flexibility**
- **Suitable for use with underfloor heating systems**
- **Pot life of 3 – 4 hours**

## Tiles

- ✓ Ceramics
- ✓ Porcelain
- ✓ Marble
- ✓ Travertine
- ✓ Limestone
- ✓ Slate
- ✓ Granite
- ✓ Terracotta
- ✓ Mosaics
- ✓ Quarry

## Substrates

- ✓ Sand/cement screed
- ✓ Concrete
- ✓ Plywood overlay (12 mm min.)
- ✓ Electric underfloor heating
- ✓ Water/wet system underfloor heating
- ✓ Tile backer boards
- ✓ Existing ceramic, porcelain and natural stone tiles\*
- ✓ Flooring grade asphalt and bitumen\*
- ✓ Calcium sulphate screeds\*\*
- ✓ Plaster
- ✓ Plasterboard
- ✓ Cement/sand render
- ✓ Concrete brick/block
- ✓ Existing vinyl tiles\*
- ✓ Epoxy DPM\*

\* Prime with Prime+ Grip

\*\* Additional substrate preparation required

Water addition	4.4 – 4.6 l of water to 20 kg Standard Set Setaflex
Coverage	20 kg will cover 5 – 6 m <sup>2</sup> at 3 mm thin bed application
Pot life at 20 °C	approximately 3 – 4 hours
Grout after	24 hours
Application temperature	+5 °C to +30 °C
Colour	grey / white
Pack sizes	20 kg
Pallet size	48 bags
Code	KA0006 – grey KA0007 – white



# Setaflex Semi-Rapid

S1 flexible semi-rapid setting floor and wall tile adhesive.



Tilemaster Setaflex Semi-Rapid is an S1 flexible, semi-rapid setting floor and wall tile adhesive with increased adhesion and non-slip properties. Setaflex Semi-Rapid is suitable for installing ceramic, porcelain and natural stone tiles to substrates subject to limited movement and/or vibration and is ideal for use above underfloor heating systems. Setaflex Semi-Rapid allows for additional working time with a pot life of 90 – 120 minutes. Setaflex Semi-Rapid can be used internally and externally and it is unaffected by frost after setting.

- **Genuine S1 flexibility**
- **Suitable for use with underfloor heating systems**
- **Walk on and grout after 6 hours**

## Tiles

- ✓ Ceramics
- ✓ Porcelain
- ✓ Marble
- ✓ Travertine
- ✓ Limestone
- ✓ Slate
- ✓ Granite
- ✓ Terracotta
- ✓ Mosaics
- ✓ Quarry

## Substrates

- ✓ Sand/cement screed
- ✓ Concrete
- ✓ Plywood overlay (12 mm min.)
- ✓ Electric underfloor heating
- ✓ Water/wet system underfloor heating
- ✓ Tile backer boards
- ✓ Existing ceramic, porcelain and natural stone tiles\*
- ✓ Flooring grade asphalt and bitumen\*
- ✓ Calcium sulphate screeds\*\*
- ✓ Plaster
- ✓ Plasterboard
- ✓ Cement/sand render
- ✓ Concrete brick/block
- ✓ Existing vinyl tiles\*
- ✓ Epoxy DPM\*

\* Prime with Prime+ Grip

\*\* Additional substrate preparation required

Water addition	4.4 – 4.6 ℓ of water to 20 kg Setaflex Semi-Rapid
Coverage	20 kg will cover 5 – 6 m <sup>2</sup> at 3 mm thin bed application
Pot life at 20 °C	approximately 90 – 120 minutes
Grout after	6 hours
Application temperature	+5 °C to +30 °C
Colour	grey / white
Pack sizes	20 kg
Pallet size	48 bags
Code	KA0041 – grey KA0042 – white



# Rapid Setaflex

S1 flexible rapid setting floor and wall tile adhesive.

Tilemaster Rapid Setaflex is an S1 flexible, rapid setting floor and wall tile adhesive with increased adhesion and non-slip properties. Rapid Setaflex is suitable for installing ceramic, porcelain and natural stone tiles to substrates subject to limited movement and/or vibration and is ideal for use above underfloor heating systems. Rapid Setaflex allows for foot traffic and grouting to commence after 3 hours. Rapid Setaflex can be used internally and externally and it is unaffected by frost after setting.



- **Genuine S1 flexibility**
- **Suitable for use with underfloor heating systems**
- **Walk on and grout after 3 hours**

## Tiles

- ✓ Ceramics
- ✓ Porcelain
- ✓ Marble
- ✓ Travertine
- ✓ Limestone
- ✓ Slate
- ✓ Granite
- ✓ Terracotta
- ✓ Mosaics
- ✓ Quarry

## Substrates

- ✓ Sand/cement screed
- ✓ Concrete
- ✓ Plywood overlay (12 mm min.)
- ✓ Electric underfloor heating
- ✓ Water/wet system underfloor heating
- ✓ Tile backer boards
- ✓ Existing ceramic, porcelain and natural stone tiles\*
- ✓ Flooring grade asphalt and bitumen\*
- ✓ Calcium sulphate screeds\*\*
- ✓ Plaster
- ✓ Plasterboard
- ✓ Cement/sand render
- ✓ Concrete brick/block
- ✓ Existing vinyl tiles\*
- ✓ Epoxy DPM\*

\* Prime with Prime+ Grip

\*\* Additional substrate preparation required

Water addition	4.4 – 4.6 l of water to 20 kg Rapid Setaflex
Coverage	20 kg will cover 5 – 6 m <sup>2</sup> at 3 mm thin bed application
Pot life at 20 °C	approximately 30 – 45 minutes
Grout after	3 hours
Application temperature	+5 °C to +30 °C
Colour	grey / white
Pack sizes	20 kg
Pallet size	48 bags
Code	KA0036 – grey KA0038 – white



# Ultimate

S2 flexible rapid setting floor and wall tile adhesive.

Tilemaster Ultimate is an S2 highly flexible, high specification floor and wall tile adhesive. Ultimate is ideal when fixing to surfaces subject to limited movement and/or vibration as well as on green screeds. Ultimate is rapid setting and allows for foot traffic and grouting after 3 hours. Ultimate can be used internally and externally and it is unaffected by frost after setting.



- **Genuine S2 flexibility**
- **Suitable for use onto green cementitious screeds**
- **Ideal for installing ceramic, porcelain, natural stone and quartz tiles**

## Tiles

- ✓ Ceramics
- ✓ Porcelain
- ✓ Marble
- ✓ Travertine
- ✓ Limestone
- ✓ Slate
- ✓ Quartz
- ✓ Granite
- ✓ Composite
- ✓ Terracotta
- ✓ Mosaics
- ✓ Quarry

## Substrates

- ✓ Sand/cement screed
- ✓ Concrete
- ✓ Plywood overlay (6 mm min.)
- ✓ Electric underfloor heating
- ✓ Water/wet system underfloor heating
- ✓ Tile backer boards
- ✓ Existing ceramic, porcelain and natural stone tiles\*
- ✓ Flooring grade asphalt and bitumen\*
- ✓ Calcium sulphate screeds\*\*
- ✓ Plaster
- ✓ Plasterboard
- ✓ Cement/sand render
- ✓ Concrete brick/block
- ✓ T & G floorboards
- ✓ Floating floors
- ✓ Existing vinyl tiles\*
- ✓ Steel/metal surfaces\*
- ✓ Epoxy DPM\*
- ✓ Green screed

\* Prime with Prime+ Grip

\*\* Additional substrate preparation required

Water addition	3.6 – 3.8 l of water to 20 kg Ultimate
Coverage	20 kg will cover 5 – 6 m <sup>2</sup> at 3 mm thin bed application
Pot life at 20 °C	approximately 30 – 45 minutes
Grout after	3 hours
Application temperature	+5 °C to +30 °C
Colours	grey / white
Pack sizes	20 kg
Pallet size	48 bags
Code	KA0049 – grey KA0050 – white



# Grout 3000

Flexible and highly versatile fast setting wall and floor grout.



Tilemaster Grout 3000 is a highly versatile, flexible wall and floor grout offering a smooth and controlled workability. Grout 3000 is flexible and it is suitable for use on surfaces subject to limited movement and/or vibration and underfloor heating systems. Grout 3000 is suitable for grouting ceramic, porcelain and natural stone tiles. Grout 3000 has very low permeability making it ideal for areas subject to prolonged or permanent wet conditions such as walk in showers and wet rooms.

- **Suitable for 1 mm – 20 mm joint widths and depths**
- **Efflorescence free formulation**
- **Walk on after 3 hours**

## Tiles

- ✓ Ceramics
- ✓ Porcelain
- ✓ Marble
- ✓ Travertine
- ✓ Limestone
- ✓ Slate
- ✓ Quartz
- ✓ Granite
- ✓ Composite
- ✓ Terracotta
- ✓ Mosaics
- ✓ Quarry
- ✓ Glass

## Substrates

- ✓ Sand/cement screed
- ✓ Concrete
- ✓ Plywood overlay (12 mm min.)
- ✓ Electric underfloor heating
- ✓ Water/wet system underfloor heating
- ✓ Tile backer boards
- ✓ Existing ceramic, porcelain and natural stone tiles
- ✓ Flooring grade asphalt and bitumen
- ✓ Calcium sulphate screeds
- ✓ Plaster
- ✓ Plasterboard
- ✓ Cement/sand render
- ✓ Concrete brick/block
- ✓ T & G floorboards\*
- ✓ Floating floors\*
- ✓ Existing vinyl tiles
- ✓ Steel/metal surfaces\*
- ✓ Green screed

\* when mixed with Flexmaster additive

## Coverage chart per 5 kg unit Grout 3000

Tile size	3 mm joint	6 mm joint	12 mm joint
Mosaic: 24x24x10	1.2 m <sup>2</sup>	0.6 m <sup>2</sup>	0.3 m <sup>2</sup>
150x150x8	10 m <sup>2</sup>	5 m <sup>2</sup>	2.5 m <sup>2</sup>
300x300x10	17 m <sup>2</sup>	9 m <sup>2</sup>	4.5 m <sup>2</sup>
600x600x10	30 m <sup>2</sup>	15 m <sup>2</sup>	7.5 m <sup>2</sup>

Water addition	5 kg Grout 3000 requires 1.2 – 1.35 l of water
Pot life at 20 °C	approximately 30 – 45 minutes
Curing time	walk on after 3 hours, allow 24 hours before contact with water, allow 28 days before submerging in water
Application temperature	+5 °C to +30 °C
Colours	18 colours available, see page 47
Pack sizes	5 kg
Pallet size	see page 47
Code	see page 47





# Silicone 3000+

Premium, mould resistant, low modulus silicone sealant.

Tilemaster Silicone 3000+ is a premium, highly flexible and high performance neutral cure, low modulus silicone sealant for walls and floors and for use with natural stone tiles. Silicone 3000+ contains Anti-Mould technology that will protect against mould growth and is waterproof, making it ideal for use in areas subject to prolonged wet conditions such as showers and wet rooms. Silicone 3000+ is suitable for interior and exterior use.



- **Neutral cure, low modulus, non-staining formulation**
- **Suitable for use with natural stone tiles**
- **Solvent free and low odour**

## Tiles

- |               |              |
|---------------|--------------|
| ✓ Ceramics    | ✓ Granite*   |
| ✓ Porcelain   | ✓ Composite* |
| ✓ Marble*     | ✓ Terracotta |
| ✓ Travertine* | ✓ Mosaics    |
| ✓ Limestone*  | ✓ Glass      |
| ✓ Slate       | ✓ Quarry     |
| ✓ Quartz*     |              |

\* Certain types of sensitive natural stone may be prone to discolouration or staining with the use of silicone sealant. We recommend testing the silicone before application.

## Application areas/environments

- ✓ Domestic and commercial showers
- ✓ Bathrooms and wetrooms
- ✓ Domestic and commercial kitchens
- ✓ Areas subject to prolonged wet conditions
- ✓ Movement joints in tiling installations
- ✓ Window and door fittings

Coverage	8.5 linear metres using a 6x6 mm bead size per 310 ml cartridge forms a skin after 30 – 60 minutes
Curing time	cures at a rate of 3 – 4 mm per day allow 3 days before contact with water
Application temperature	+5 °C to +30 °C
Colours	18 colours to match Grout 3000, see page 47
Pack sizes	310 ml cartridge
Pallet size	1200 cartridges
Code	see page 47



# Grout 3000 and Silicone 3000+ codes

Code		Pack	Pallet
<b>Grout 3000</b>			
K82331	Pure White	5 kg	144 pcs.
K82332	Jasmine	5 kg	144 pcs.
K82333	Beige	5 kg	144 pcs.
K82335	Limestone	5 kg	144 pcs.
K82334	Sandstone	5 kg	144 pcs.
K82337	Light Grey	5 kg	144 pcs.
K82339	Mid Grey	5 kg	144 pcs.
K82338	Natural Grey	5 kg	144 pcs.
K82340	Dark Grey	5 kg	144 pcs.
K82330	Charcoal	5 kg	144 pcs.
K82346	Black	5 kg	144 pcs.
K82336	Almond	5 kg	144 pcs.
K82347	Aspen	5 kg	144 pcs.
K82345	Gravel	5 kg	144 pcs.
K82342	Cedar	5 kg	144 pcs.
K82344	Pecan	5 kg	144 pcs.
K82343	Hazelnut	5 kg	144 pcs.
K82341	Oak	5 kg	144 pcs.
<b>Silicone 3000+</b>			
KA0152	Pure White	310 ml	1200 pcs.
KA0145	Jasmine	310 ml	1200 pcs.
KA0139	Beige	310 ml	1200 pcs.
KA0149	Limestone	310 ml	1200 pcs.
KA0155	Sandstone	310 ml	1200 pcs.
KA0147	Light Grey	310 ml	1200 pcs.
KA0150	Mid Grey	310 ml	1200 pcs.
KA0151	Natural Grey	310 ml	1200 pcs.
KA0144	Dark Grey	310 ml	1200 pcs.
KA0141	Charcoal	310 ml	1200 pcs.
KA0340	Black	310 ml	1200 pcs.
KA0137	Almond	310 ml	1200 pcs.
KA0339	Aspen	310 ml	1200 pcs.
KA0342	Gravel	310 ml	1200 pcs.
KA0341	Cedar	310 ml	1200 pcs.
KA0345	Pecan	310 ml	1200 pcs.
KA0343	Hazelnut	310 ml	1200 pcs.
KA0344	Oak	310 ml	1200 pcs.

# Grout 3000 and Silicone 3000+ colours

Oak	
Hazelnut	
Pecan	
Cedar	
Gravel	
Aspen	
Almond	
Sandstone	
Beige	
Jasmine	
Pure White	
Limestone	
Light Grey	
Natural Grey	
Mid Grey	
Dark Grey	
Charcoal	
Black	

*Please note: colours shown are for illustration purposes. Actual colours may vary slightly from the printed colours.*

# Tile adhesive selector

SUBSTRATE	CERAMIC	PORCELAIN
<b>INTERIOR WALLS</b>		
Gypsum plaster	D E	D E
Gypsum plasterboard	D E	D E
Sand/cement render	D E	D E
Concrete block	D E	D E
Existing ceramic, porcelain & natural stone tiles	D E	D E
Tile backer board fixed to solid substrates (e.g. blockwork/brick)	D E	D E
Tile backer board fixed to timber framework	D E	D E
Plywood	D E	D E
<b>INTERIOR FLOORS</b>		
Sand/cement screed	A B C D	A B C D
Concrete	A B C D	A B C D
Anhydrite/gypsum screed	B D E	B D E
Flooring grade asphalt and bitumen	A B C D	A B C D
Existing ceramic, porcelain & natural stone tiles	A B C D	A B C D
Existing vinyl tiles/sheet vinyl	A B C D	A B C D
Plywood overlay	A B C D	A B C D
T & G floorboards	C	C
Floating floors	C	C
Metal/steel	C	C
Tile backer board fixed to solid substrates (e.g. sand/cement screed)	A B C D	A B C D
Tile backer board fixed to timber substrate	A B C D	A B C D
Electric undertile heating	A B C D	A B C D
Underfloor heated screeds	A B C D	A B C D
Tilemaster Anti-fracture Mat and uncoupling membranes	A B C D	A B C D
Green screed	C	C
<b>EXTERIOR WALLS AND FLOORS</b>		
Concrete block	D E	D E
Sand/cement render	D E	D E
Existing ceramic, porcelain & natural stone tiles	D E	D E
Sand/cement screed	A B C D	A B C D
Concrete	A B C D	A B C D
Green screed	C	C

**A** Trade FlexiRapid

**B** Rapid Setaflex

**C** Ultimate

Note: in most cases our recommended adhesive is standard setting for walls and rapid setting for floors. The equivalent standard/rapid setting adhesive is also suitable

NATURAL STONE	QUARRY & TERRACOTTA	MOSAICS	QUARTZ & COMPOSITE
<b>INTERIOR WALLS</b>			
<b>INTERIOR FLOORS</b>			
			<b>N/A</b>
<b>EXTERIOR WALLS AND FLOORS</b>			
			<b>N/A</b>
			<b>N/A</b>
			<b>N/A</b>
			<b>N/A</b>
			<b>N/A</b>
			<b>N/A</b>

**Setaflex Semi-Rapid**

**Standard Set Setaflex**



# Laying resilient flooring

46 Eco-3000 HT

47 Eco-3000 PS

# Eco-3000 HT

Universal, high temperature resilient flooring adhesive.

Tilemaster Eco-3000 HT is a universal, high temperature, solvent free flooring adhesive suitable for installing a wide variety of floor coverings to a wide variety of substrates. Tilemaster Eco-3000 HT has been specially developed to provide excellent adhesion properties, with a high shear strength and a hard set once cured. Tilemaster Eco-3000 HT is a high temperature adhesive, making it ideal for use onto substrates that have underfloor heating installed; it is also suitable for installations that may be subject to direct sunlight such as orangeries, conservatories and any other glass-fronted buildings. Tilemaster Eco-3000 HT is a wet set adhesive, and can receive floor coverings within the products working time of approximately 40 minutes dependent on site conditions.



- **High temperature – ideal for use above underfloor heating systems**
- **40 minute working time**
- **High shear bond strength**

## Floor coverings

- ✓ LVT
- ✓ PVC
- ✓ PVC backed carpet
- ✓ Sheet vinyl

Coverage with A2 trowel	15 kg will cover 50 – 60 m <sup>2</sup>
Semi-wet tack time at 23 °C	10 minutes
Time to foot traffic at 23 °C	12 hours
Cure time at 23 °C	24 hours
Minimum application temperature	15 °C and rising
Colour	cream
Pack size	15 kg
Pallet size	44 buckets
Code	K18860





# Eco-3000 PS

Pressure sensitive resilient flooring adhesive.



Tilemaster Eco-3000 PS is a pressure sensitive, solvent free flooring adhesive suitable for the installation of LVT floor coverings, specifically for design floors or where intricate designs are being installed. Tilemaster Eco-3000 PS has been specially developed to provide a short open time and high bond strength. Tilemaster Eco-3000 PS is a pressure sensitive adhesive, making it ideal for use onto substrates that are having LVT floor coverings installed. The short open time of Tilemaster Eco-3000 PS gives high initial grab when installing design floors, or intricate designs that demand a higher level of detail and in turn an excellent final bond strength. Formulated to give a fast tacking off time, Tilemaster Eco-3000 PS can be installed into in as little as 10 - 20 minutes.

- **Pressure Sensitive – ideal for design flooring and intricate designs**
- **Apply floor coverings in as little as 10 minutes**
- **Excellent initial grab**

## Floor coverings

- ✓ LVT
- ✓ PVC
- ✓ PVC backed carpet
- ✓ Sheet vinyl

Coverage with A2 trowel	15 kg will cover 80 – 90 m <sup>2</sup>
Tack time at 23 °C	10 minutes
Cure time at 23 °C	24 hours
Minimum application temperature	15 °C and rising
Colour	cream
Pack size	15 kg
Pallet size	44 buckets
Code	KA0433





# Laying systems

- 50 Substrate priming guide
- 52 Tiling to calcium sulphate screeds
- 53 Tiling to flooring grade bitumen and asphalt substrates
- 54 Tiling to heated screeds with natural stone tiles
- 55 Tiling to Class 3 plywood (overlay)
- 56 Tiling to existing tiles/vinyl flooring
- 57 Tiling to tile backer boards
- 58 Tiling to overlay heating system
- 59 Tiling to sand/cement render, concrete block,  
sand/cement screed, concrete base
- 60 Tiling to gypsum plaster, gypsum plasterboards
- 61 Tiling to steel/metal substrates

# Substrate priming guide

Before tiling or applying a smoothing and levelling floor compound, the majority of substrates will require priming. Priming the substrates will:

- improve the adhesion of tile adhesives and smoothing compounds
- reduce the porosity of porous substrates
- stabilize and seal substrates
- extend the working time of the tile adhesives and smoothing compounds

**Start with - improving adhesion;** Prime+ Grip or Primeplus slurry mix improves the adhesion of tile adhesives and levellers to non-absorbent substrates.

**Start with - substrate consolidation;** Prime+ Grip or Primeplus slurry help stop contaminants from being drawn out of contaminated substrates.



**Primeplus** and **Prime+ Grip** are both excellent primers suitable for priming a large variety of surfaces. Prior to applying primer, you must ensure that the surface is dry and free of any contaminants, loose dust or dirt. **Primeplus** is diluted accordingly for the substrate type, see table below. **Prime+ Grip** is always applied neat. **The primer must be touch dry before tile adhesive or self levelling floor compound is applied.**

**NOTE:** if substrates are overly porous, then further coats of primer may be required.

## WALLS

Substrate	Dilution rate and application instructions
<b>Gypsum Plaster</b>	Prime the surface with one coat of <b>Primeplus</b> , diluted 3 parts water to 1 part primer. Alternatively apply one coat of <b>Prime+ Grip</b> .
<b>Gypsum Plasterboard</b>	Prime the surface with one coat of <b>Primeplus</b> diluted 3 parts water to 1 part primer. Alternatively apply one coat of <b>Prime+ Grip</b> .
<b>Sand/Cement Render</b>	Prime the surface with one coat of <b>Primeplus</b> diluted 3 parts water to 1 part primer. Alternatively apply one coat of <b>Prime+ Grip</b> .
<b>Concrete Blocks</b>	Prime the surface with one coat of <b>Primeplus</b> diluted 3 parts water to 1 part primer. Alternatively apply one coat of <b>Prime+ Grip</b> .
<b>Existing Tiles</b>	Apply one coat of <b>Prime+ Grip</b> . *Alternatively apply one coat of <b>Primeplus</b> slurry mix.
<b>Tile Backer Boards</b>	Prime the surface with one coat of <b>Primeplus</b> diluted 3 parts water to 1 part primer. Alternatively apply one coat of <b>Prime+ Grip</b> .

## FLOORS

Substrate	Dilution rate and application instructions
<b>Sand/Cement Screed</b>	Prime the surface with one coat of <b>Primeplus</b> diluted 3 parts water to 1 part primer. Alternatively apply one coat of <b>Prime+ Grip</b> .
<b>Concrete</b>	Prime the surface with one coat of <b>Primeplus</b> diluted 3 parts water to 1 part primer. Alternatively apply one coat of <b>Prime+ Grip</b> .
<b>Calcium Sulphate Screeds</b>	Prime the surface with one coat of <b>Primeplus</b> diluted 3 parts water to 1 part primer. Once dry, apply a second, neat coat of <b>Primeplus</b> .
<b>Flooring Grade Plywood</b>	Prime the surface with one coat of <b>Primeplus</b> diluted 3 parts water to 1 part primer. Alternatively apply one coat of <b>Prime+ Grip</b> .
<b>T&amp;G Timber Floorboards</b>	Prime the surface with one coat of <b>Primeplus</b> diluted 3 parts water to 1 part primer. Alternatively apply one coat of <b>Prime+ Grip</b> . <i><b>NOTE:</b> chipboard flooring should not have tile adhesive or self levelling compounds applied to them directly. Consult the Technical Data Sheet (TDS) of the respective chipboard manufacturers product to be installed onto.</i>
<b>Existing Tiles</b>	Apply one coat of <b>Prime+ Grip</b> . *Alternatively apply one coat of <b>Primeplus</b> slurry mix
<b>Existing Vinyl Tiles/Sheet Vinyl</b>	Apply one coat of <b>Prime+ Grip</b> . *Alternatively apply one coat of <b>Primeplus</b> slurry mix
<b>Flooring Grade Asphalt &amp; Bitumen</b>	Apply one coat of <b>Prime+ Grip</b> . *Alternatively apply one coat of <b>Primeplus</b> slurry mix
<b>Steel/Metal</b>	Apply one coat of <b>Prime+ Grip</b> . *Alternatively apply one coat of <b>Primeplus</b> slurry mix
<b>Green Screed</b>	Prime the surface with one coat of Primeplus diluted 3 parts water to 1 part Primeplus. Alternatively apply one coat of <b>Prime+ Grip</b> .
<b>Tile Backer Boards</b>	Prime the surface with one coat of <b>Primeplus</b> diluted 3 parts water to 1 part primer. Alternatively apply one coat of <b>Prime+ Grip</b> .

*\*Slurry coat: Primeplus diluted 1 to 1 with water mixed with approximately 30% by weight of cement based tile adhesive, grout or smoothing compound to form a brush on slurry/gritty primer.*

# Tiling to calcium sulphate screeds

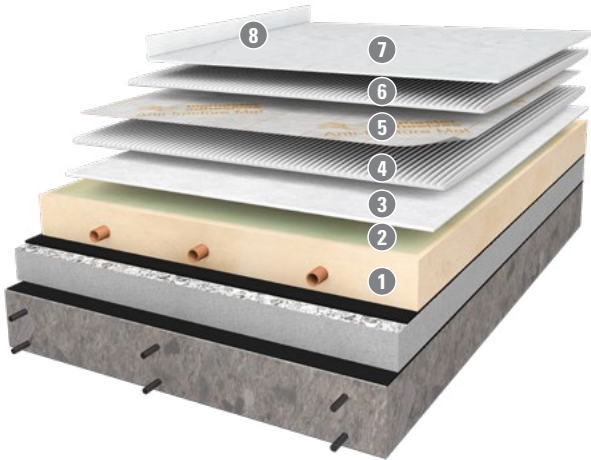

- |   |                              |
|---|------------------------------|
| 1 | Calcium sulphate screed      |
| 2 | Primeplus                    |
| 3 | LevelFlex+ DEPTH             |
| 4 | Rapid Setaflex               |
| 5 | Tilemaster Anti-Fracture Mat |
| 6 | Rapid Setaflex               |
| 7 | Grout 3000                   |
| 8 | Silicone 3000+               |

- Laitance must be removed before work commences by mechanically sanding and/or abrading the surface of the screed.
- The surface must then be vacuumed to remove all loose dust, dirt and contaminants.
- Calcium sulphate screeds must be confirmed dry via consistent moisture readings across the whole floor. Cement based adhesive the residual moisture content must be less than 0.5% or the RH below 75%.
- Underfloor heating systems must be commissioned prior to tiling via the manifold mixing valve, or at the boiler. To commission the underfloor heating properly the flow temperature should not be limited by room thermostats. The room thermostats should be disconnected and the temperatures controlled manually via the manifold mixing valve, or at the boiler.
- The drying of calcium sulphate screeds can also be accelerated with the use of dehumidifiers.
- If required, **LevelFlex+ DEPTH** can be applied to smooth out or level the surface prior to tiling works commencing.
- Prime the surface of the screed with 2 coats of **Primeplus**. The first coat must be diluted with 3 parts water and allowed to dry before applying a second, neat coat of **Primeplus**.
- For fixing **Tilemaster Anti-Fracture Mat** use **Rapid Setaflex**, using an appropriate sized trowel.
- Tiling to be carried out using **Rapid Setaflex**, allow to dry before grouting.
- Grouting to be carried out with **Grout 3000**, allow to dry before applying **Silicone 3000+**.

# Tiling to flooring grade bitumen and asphalt substrates

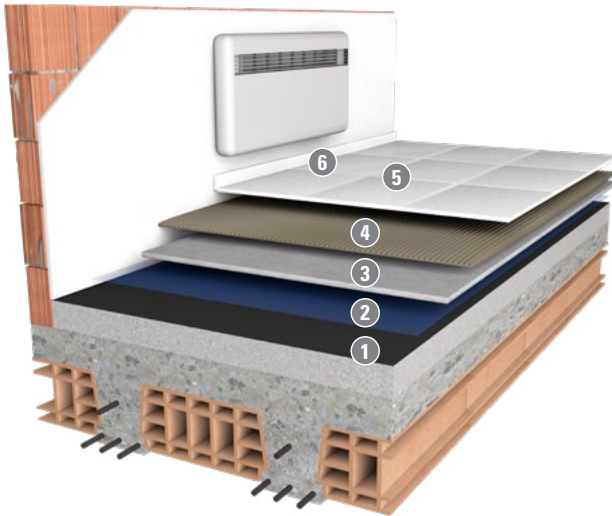

- 1 Bitumen/asphalt substrate
- 2 Prime+ Grip
- 3 LevelFlex+ DEPTH
- 4 Rapid Setaflex
- 5 Grout 3000
- 6 Silicone 3000+

- Ensure the surface is dry and free of any contaminants, loose dust or dirt.
- Make sure that the asphalt/bitumen is in good condition, free from cracks and that there are no signs of debonding and/or hollowness.
- Prime the surface with one coat of **Prime+ Grip** and allow to dry. Alternatively prime the surface with one coat of **Primeplus** slurry mix and allow to dry before continuing.
- If required, **LevelFlex+ DEPTH** can be installed to smooth out or level the surface prior to tiling works commencing.
- Tiling to be carried out using **Rapid Setaflex**, allow to dry before grouting.
- Grouting to be carried out with **Grout 3000**, allow to dry before applying **Silicone 3000+**.

# Tiling to heated screeds with natural stone tiles

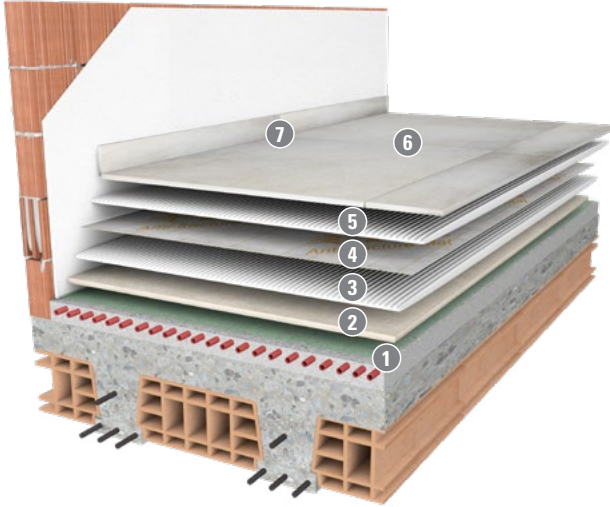

- |   |                              |
|---|------------------------------|
| 1 | Primeplus                    |
| 2 | Rapid Level 30               |
| 3 | Setaflex Semi-Rapid          |
| 4 | Tilemaster Anti-Fracture Mat |
| 5 | Setaflex Semi-Rapid          |
| 6 | Grout 3000                   |
| 7 | Silicone 3000+               |

- Make sure the original substrate is solid, stable and in good condition.
- Ensure the surface is dry and free of any contaminants, loose dust or dirt.
- Prime the surface with one coat of **Primeplus** diluted 3 parts water to 1 part primer. Alternatively apply one coat of **Prime+ Grip**.
- If required, **Rapid Level 30** can be installed to smooth out or level the surface prior to tiling works commencing.
- Apply **Setaflex Semi-Rapid** adhesive using an appropriate sized trowel and fix **Tilemaster Anti-Fracture Mat** within the adhesive's open time.
- When using **Tilemaster Anti-Fracture Mat**, tiling can commence immediately after laying the Anti-Fracture Mat.
- Tiling to be carried out using **Setaflex Semi-Rapid**, allow to dry before grouting.
- Grouting to be carried out with **Grout 3000**, allow to dry before applying **Silicone 3000+**.



# Tiling to flooring grade plywood (overlay)

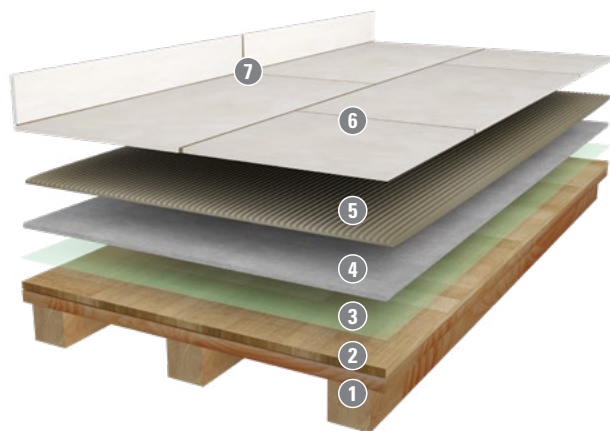

- 1 Wooden substrate
- 2 Plywood sheet
- 3 Primeplus
- 4 LevelFlex+ DEPTH
- 5 Ultimate
- 6 Grout 3000
- 7 Silicone 3000+

- Plywood must be flooring grade and of the required thickness for the chosen tile adhesive.
- New or existing boards must be conditioned to the environment in which they will be used.
- Stagger the joints when fixing the plywood, leaving a 0.5 – 1 mm gap between boards.
- Plywood must be screwed (not nailed) to the substrate at 150 mm centres.
- Ensure the surface is dry and free of any contaminants, loose dust or dirt.
- Prime the surface with one coat of **Primeplus** diluted 3 parts water to 1 part primer. Alternatively apply one coat of **Prime+ Grip**.
- If required, **LevelFlex+ DEPTH** can be installed to smooth out or level the surface prior to tiling works commencing.
- Tiling to be carried out using **Tilemaster Ultimate** adhesive, allow to dry before grouting.
- Grouting to be carried out with **Grout 3000**, allow to dry before applying **Silicone 3000+**.

# Tiling to existing tiles/ vinyl flooring

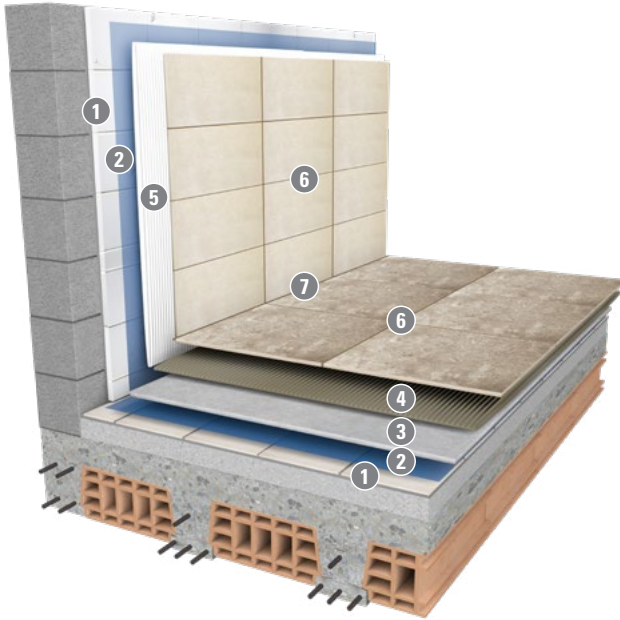

- |   |                       |
|---|-----------------------|
| 1 | Existing tiles        |
| 2 | Prime+ Grip           |
| 3 | LevelFlex+ DEPTH      |
| 4 | Trade FlexiRapid      |
| 5 | Standard Set Setaflex |
| 6 | Grout 3000            |
| 7 | Silicone 3000+        |

- Make sure existing tiles are firmly bonded to the original substrate.
- Remove any loose tiles and make good.
- Ensure the surface is dry and free of any contaminants, loose dust or dirt.
- Existing tiles that have been previously treated with a sealer must be sufficiently cleaned in order to remove any surface treatments.
- Prime the surface with one coat of **Prime+ Grip** and allow to dry. Alternatively prime the surface with one coat of **Primeplus** slurry mix and allow to dry before continuing.
- If required, **LevelFlex+ DEPTH** can be installed to smooth out or level the surface prior to tiling works commencing.
- Tiling to floors to be carried out using **Trade FlexiRapid** adhesive and with **Standard Set Setaflex** for the walls, allow to dry before grouting.
- Grouting to be carried out with **Grout 3000**, allow to dry before applying **Silicone 3000+**.

# Tiling to tile backer boards

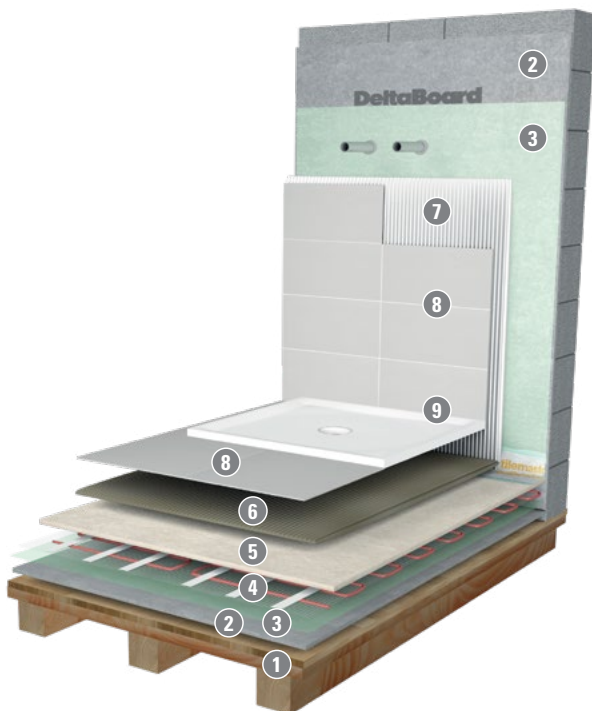

- |   |                             |
|---|-----------------------------|
| 1 | Wooden substrate            |
| 2 | Cement board                |
| 3 | Primeplus                   |
| 4 | Electric underfloor heating |
| 5 | Rapid Level 30              |
| 6 | Rapid Setaflex              |
| 7 | Setaflex Semi-Rapid         |
| 8 | Grout 3000                  |
| 9 | Silicone 3000+              |

- Prime the surface with one coat of **Primeplus** diluted 3 parts water to 1 part primer. Alternatively apply one coat of **Prime+ Grip**.
- Fix the tile backer boards with a solid bed of adhesive and mechanically fix the boards to the substrate at 300 mm centres. Alternatively follow the fixing instructions of the board manufacturer.
- Use jointing tape to reinforce the joints if necessary.
- Before tiling commences, make sure that the adhesive used to fix the boards has set.
- Ensure the surface is dry and free of any contaminants, loose dust or dirt.
- Prime the surface with one coat of **Primeplus** diluted 3 parts water to 1 part primer. Alternatively apply one coat of **Prime+ Grip**.
- If required, **Rapid Level 30** can be installed to smooth out or level the surface prior to tiling works commencing.
- Tiling to floors to be carried out using **Rapid Setaflex** adhesive and with **Setaflex Semi-Rapid** for the walls, allow to dry before grouting.
- Grouting to be carried out with **Grout 3000**, allow to dry before applying **Silicone 3000+**.

# Tiling to overlay heating system

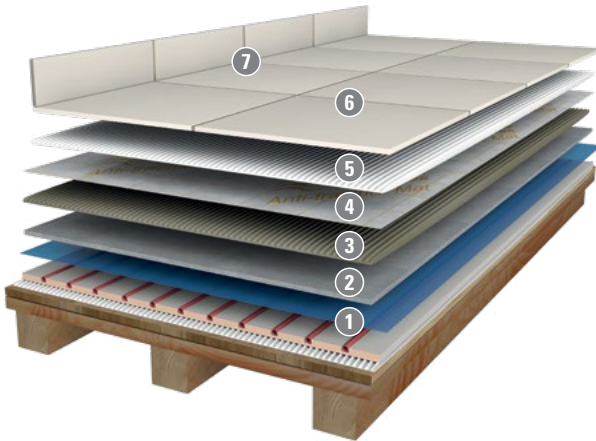

- 1 Prime+ Grip
- 2 LevelFlex+ DEPTH
- 3 Rapid Setaflex
- 4 Tilemaster Anti-Fracture Mat
- 5 Rapid Setaflex
- 6 Grout 3000
- 7 Silicone 3000+

- Make sure the original substrate is firm, stable and in good condition.
- Ensure the surface is dry and free of any contaminants, loose dust or dirt.
- Prime the surface with one coat of **Prime+ Grip**.
- Apply **LevelFlex+ DEPTH** to the surface prior to tiling works commencing.
- Apply a solid bed of adhesive and lay the uncoupling membrane while the adhesive is still moist.
- When using **Tilemaster Anti-Fracture Mat**, tiling can commence immediately after laying the Anti-Fracture Mat.
- For fixing **Tilemaster Anti-Fracture Mat** use **Rapid Setaflex**, using an appropriate sized trowel.
- Tiling to be carried out using **Rapid Setaflex**, allow to dry before grouting.
- Grouting to be carried out with **Grout 3000**, allow to dry before applying **Silicone 3000+**.

# Tiling to sand/cement render, concrete block, sand/cement screed, concrete base

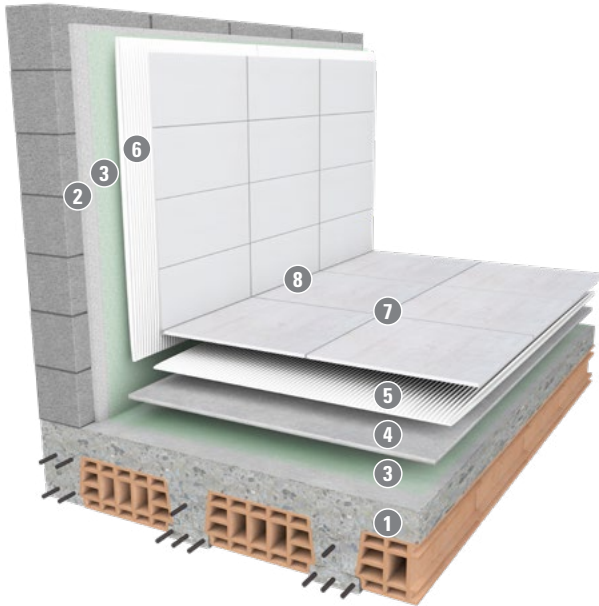

- 1 Concrete base
- 2 Sand/cement render
- 3 Primeplus
- 4 LevelFlex+ DEPTH
- 5 Rapid Setaflex
- 6 Standard Set Setaflex
- 7 Grout 3000
- 8 Silicone 3000+

- New **concrete** must be allowed a minimum of 6 weeks drying time.
- New **sand/cement screed** must be left for a minimum of 4 weeks to dry sufficiently.
- Before tiling, mechanically remove any laitance from the surface of the **concrete** and remove all dust by vacuum. Ensure the surface is dry and free of any contaminants, loose dust or dirt.
- Remove any loose flaking layers from the **sand/cement screed** and ensure that the surface is dry and free of any contaminants, loose dust or dirt.
- Prime the surface with one coat of **Primeplus** diluted 3 parts water to 1 part primer. Alternatively apply one coat of **Prime+ Grip**.
- If required, **LevelFlex+ DEPTH** can be installed to smooth out or level the surface prior to tiling works commencing.
- Tiling to floors to be carried out using **Rapid Setaflex** adhesive and with **Standard Set Setaflex** for the walls, allow to dry before grouting.
- Grouting to be carried out with **Grout 3000**, allow to dry before applying **Silicone 3000+**.

# Tiling to gypsum plaster, gypsum plasterboards



- 1 Plasterboard
- 2 Gypsum plaster
- 3 Primeplus
- 4 Standard Set Setaflex
- 5 Grout 3000
- 6 Silicone 3000+

## Gypsum Plasterboard

- Ensure the boards are securely fixed to the substrate. If onto framework, boards must be screwed at 300 mm centres.
- Ensure the surface is dry and free of any contaminants, loose dust or dirt.
- Prime the surface with one coat of **Primeplus** diluted 3 parts water to 1 part primer. Alternatively apply one coat of **Prime+ Grip**.
- Maximum weight when tiling to plasterboard is 32 kg/m<sup>2</sup> inc tiles, adhesive and grout.
- Tiling to be carried out using **Standard Set Setaflex** adhesive, allow to dry before grouting.
- Grouting to be carried out with **Grout 3000**, allow to dry before applying **Silicone 3000+**.

## Gypsum Plaster

- Allow 4 weeks minimum for new plaster to dry.
- Ensure the surface is dry and free of any contaminants, loose dust or dirt.
- If the plaster has a polished/shiny surface, brush with a stiff bristle brush to abrade/roughen the surface prior to application.
- Prime the surface with one coat of **Primeplus** diluted 3 parts water to 1 part primer. Alternatively apply one coat of **Prime+ Grip**.
- Maximum weight when tiling to plaster is 20 kg/m<sup>2</sup> inc tiles, adhesive and grout.
- Tiling to be carried out using **Standard Set Setaflex** adhesive, allow to dry before grouting.
- Grouting to be carried out with **Grout 3000**, allow to dry before applying **Silicone 3000+**.

# Tiling to steel/metal substrates

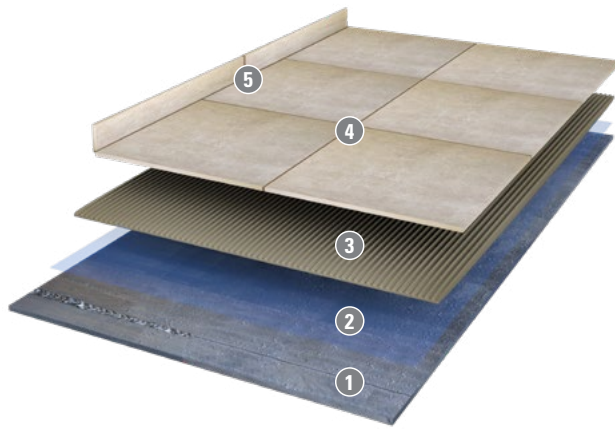

- 1 Steel/metal substrate
- 2 Prime+ Grip
- 3 Ultimate
- 4 Grout 3000 and Flexmaster
- 5 Silicone 3000+

- Make sure the surface is free of any contaminants, loose dust or dirt and if required degrease the surface of the substrate.
- Prime the surface with one coat of **Prime+ Grip** and allow to dry. Alternatively prime the surface with one coat of **Primeplus** slurry mix and allow to dry before continuing.
- Tiling to be carried out using **Tilemaster Ultimate** adhesive, allow to dry before grouting.
- Grouting to be carried out with **Grout 3000** and **Flexmaster** additive, allow to dry before applying **Silicone 3000+**.

# Notes

A series of horizontal dotted lines for writing notes.



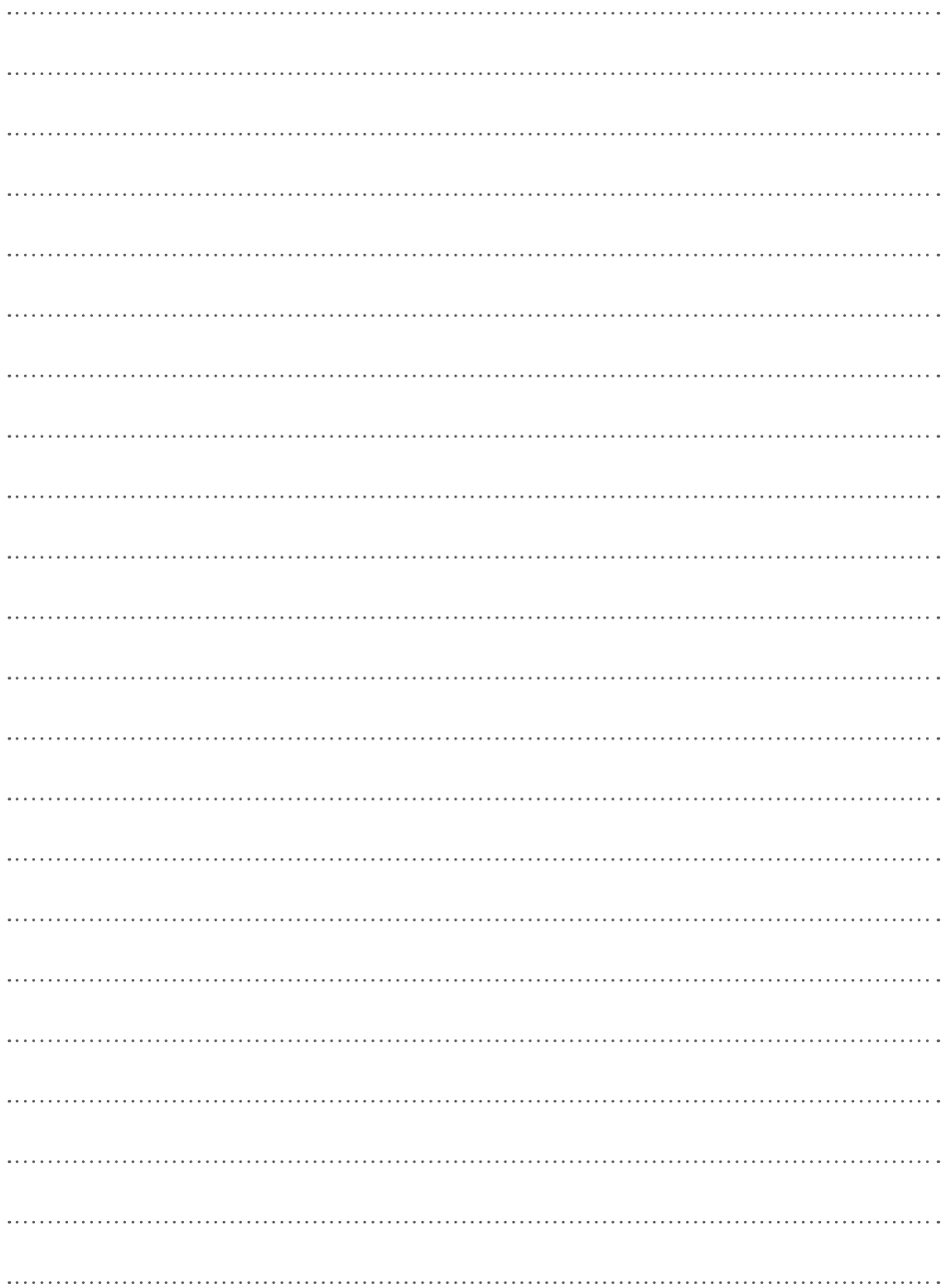

# Notes

.....

.....

.....

.....

.....

.....

.....

.....

.....

.....

.....

.....

.....

.....

.....

.....

.....

.....

.....

.....

.....

.....

.....

.....

.....

.....





**TILEMASTER ADHESIVES Ltd. - KERAKOLL GROUP**  
Tomlinson Road, Leyland, Lancashire PR25 2DY, United Kingdom  
Tel +44 01772 456 831  
[www.tilemasteradhesives.co.uk](http://www.tilemasteradhesives.co.uk) [www.kerakoll.com](http://www.kerakoll.com)